



Filling tank systems with AdBlue®

AdBlue® is an ultra pure, aggressive and corrosive urea solution used for reducing exhaust gas in Selective Catalysator Reduction (SCR) technology. This is to comply with the Euro 5 norm requirement to reduce toxic oxides, particle emissions and diesel consumption.

AdBlue® is supplied in tank systems equipped with a pump, an electronic volume meter with display and a hose reel, depending on the equipment. The Recordall® RCDL volume meter, made of special materials, is the ideal meter for this application. With a register and a pulse output for the control of solenoid valves and the remote data transfer, the RCDL is a low-cost solution for a variety of AdBlue® tank systems.

Principle of an AdBlue® tank system

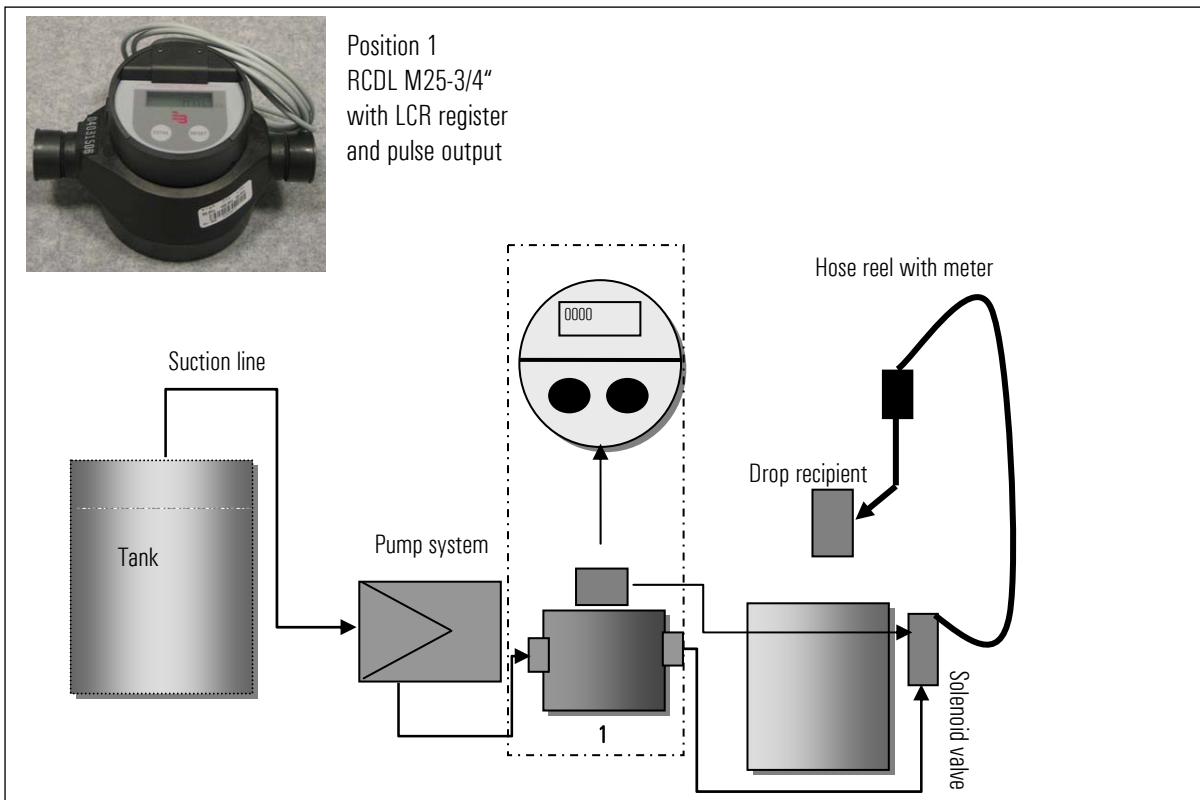

Measured variable	Volume	$V = \int Q dt$
Measuring principle	Positive displacement	Nutating disc meter
Type of flow meter	Recordall® RCDL	Type RCDL M LCR